



HOLMER

TerraDOS



GB-9707

6 row tanker harvester

**A Profitable
Technique:**

The New

**Terra
DOS**



Harvesting Process:

- ◆ Topping and lifting in front of the harvester wheels from undisturbed soil
- ◆ The flail toppler chops up the leaves
- ◆ Optional: Leaves can be evenly spread for easy ploughing in, or loaded directly on a trailer running alongside
- **Spreading width** of spreader **steplessly variable** from the cab
- ◆ Self compensating adjustable scalpels ensure an optimum topping quality
- ◆ Walking shares lift beet cleanly with minimal losses
- ◆ For extreme or very weedy conditions, walking shares feature 2 speeds
- ◆ Gentle, but effective cleaning of beet on 7 spiral roller bed, transfer web and 3 adjustable turbines



- ◆ **Optimum 50-50 front/rear weight distribution**, regardless of whether the tank is full or empty
- ◆ The **Terra's large-size tyres** minimise soil compaction
- ◆ Beet is transferred to holding tank by a ring elevator, then distributed by the tank auger
- ◆ The beet is discharged by a wide discharge elevator with a swan neck
- ◆ Transverse and longitudinal slat conveyors accelerate the unloading process

**A long
cleaning path
is vital for effective soil
removal**

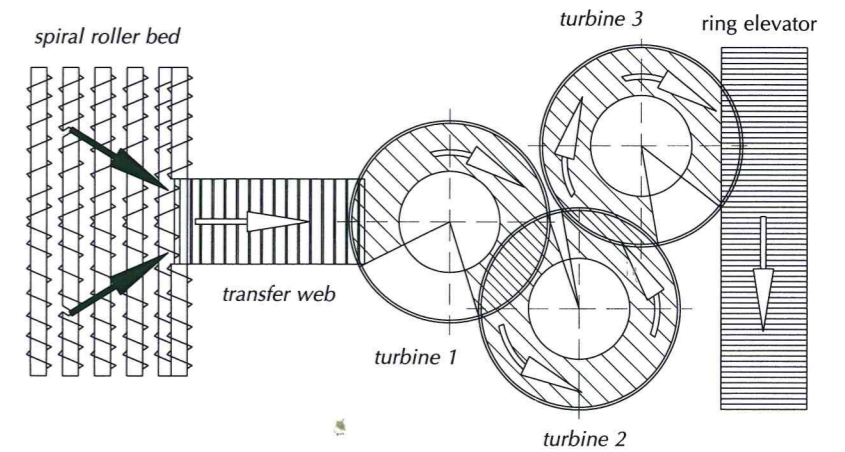

- ◆ Transfer conveyor speed and tension are adjustable, web is reversible
- ◆ Independent speed setting of each turbine
- ◆ Pre-selected speeds of the transfer web and turbine steplessly adjustable from the driver's seat



- ◆ Gentle handling with efficient cleaning maintains beet quality

- ◆ Spring-loaded turbine gates,
- ◆ 3 spring tension settings
- ◆ Gates height adjustable from the driver's seat with in cab position indicator



- ◆ Big distance between wheels and beet silo
- ◆ Quick emptying of holding tank
- ◆ Partial discharge possible
- ◆ Long and wide (1,85m) discharge elevator with swan neck enables loss free unloading on the move

Flail topper and lifter

KPV 5 System: Fixed row width Walking shares and 7 cleaning rollers

VPV 5 System: Adjustable row widths Walking shares and 7 cleaning rollers

KPV 5 System: Choice of row widths
45, 48, 50, 60 or 65 cm

VPV 5 System: Adjustable row widths
45 / 50 cm, or 45 / 48 cm



Adjusting the VPV system to a different row width takes 3 minutes

- ◆ The flail topper and lifting unit follow the soil contours independently
- ◆ Depth control wheels can be adjusted independently left to right from the driver's seat (visual indicator)



- ◆ Wear resistant, **self-compensating scalpers**, ball bearing mounted
- ◆ Scalper knife to comb distance, and scalper angle adjustable from the driver's seat (visual indicator)



- Optional topping system: Feeler wheels and knives
- ◆ Hydraulic drives
 - ◆ Variable speed according to forward speed and conditions
 - ◆ Automatic adjustment of topping thickness

Diagram of the self compensating scalper system

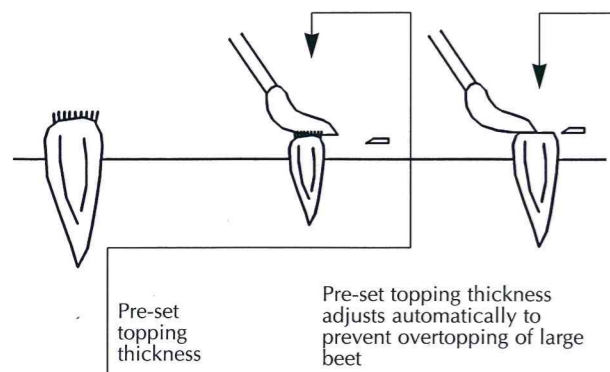

- ◆ Up to 95 % of topper weight can be transferred to the lifter to ensure penetration in hard conditions



- ◆ Excellent operator visibility of all topping and lifting functions
- ◆ Automatic depth control operates independently on left and right (visual indicator)

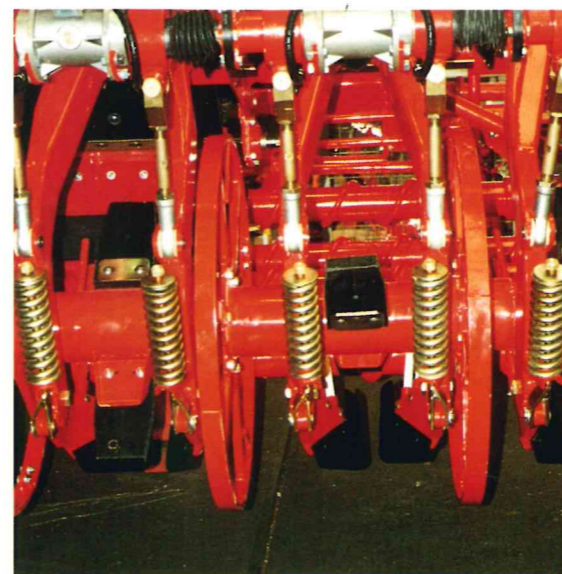

- ◆ **Maintenance free heavy duty walking share drives** running in oil bath, with 70 mm side movement allows shares to 'self seek'
- ◆ Spring loading provides **stone protection** for each share



- ◆ Generous ground clearance when topping and lifting units are lifted

Welcome Aboard!

The HOLMER cab, a perfect working environment, sophisticated, reliable systems ensure **total control and driver awareness** of all operating functions and status.

All TERRA-DOS functions are monitored electronically and graphically displayed on a **screen monitor**.

A comfortable seat and ergonomically placed controls for fatigue free work.



Additional features of the noise insulated cabin:

- ◆ Adjustable steering column, heated exterior mirrors, right mirror electrically adjustable and folded pneumatically. Mirrors adjust automatically when harvesting in 'crab' position
- ◆ Additional working lights for good night working visibility
- ◆ Upholstered passenger seat with document pocket
- ◆ Tilting roof panel for extra ventilation
- ◆ Powerful heater, radio, air conditioning optional
- ◆ Top and bottom front screens open mechanically or pneumatically
- ◆ Ventilated window

Total supervision

All controls within reach, with the joystick.
Driving is easy with the joystick in the driver's right hand, major settings can be performed at the same time.



- ◆ All important functions are at a glance

Safety features:

Clear Graphic Display:

- ◆ Rear axle position
- ◆ 'Crab' articulation position
- ◆ Turbine gate height positions
- ◆ Transfer web tension status, turbine 1 - 2 - 3, ring elevator speed

Visual and Audible Signals:

- ◆ Beet build up in the transfer web and cleaning systems
- ◆ Malfunctions in the cooling circuit, hydraulic systems or diesel engine

The **diagnostic program** enables interrogation and functional checks of all electronic systems and electric switches.

HOLMER Virtual Computer Display for:

- ◆ Forward speed
- ◆ Automatic steering
- ◆ Cruise control
- ◆ Hectares completed, each day and in total

TERRA DOS Articulation

With the additional chassis pivot point allowing articulation, **HOLMER** once again sets new standards and raises the level of beet harvesting technology

TERRA-DOS meets all current demands, and looks forward to future needs, it satisfies these with the advantage of total versatility in fast changing world



Main features of the new TERRA-DOS

- ◆ Minimum soil structure damage, machine weight spread over a greater area
- ◆ Level soil after harvester for easy cultivation/ re-drilling
- ◆ Extremely compact turning circle (9.5 m)
- ◆ Exceptional hillside performance due to hydraulic leveling

Technical Details:

Steering option, switch selected:

- ◆ Four-wheel steer
- ◆ Crab steer
- ◆ Automatic steering

Description of the Steering Combinations:

Four-wheel steer:

The front and rear wheels are actuated by the steering wheel

Crab steer:

Both front and rear wheels are steered, additionally the machine articulation is activated by the steering wheel

Automatic steer I:

The rear part of the harvester is moved to the left during lifting, so the rear wheels are just **slightly 'offset'** from the front wheels

Automatic steer II:

The rear part of the harvester is moved to the left during lifting, so the rear wheels are just **full 'offset'** from the front wheels

Automatic steer '0':

The neutral chassis position; rear wheels follow directly behind the front ones

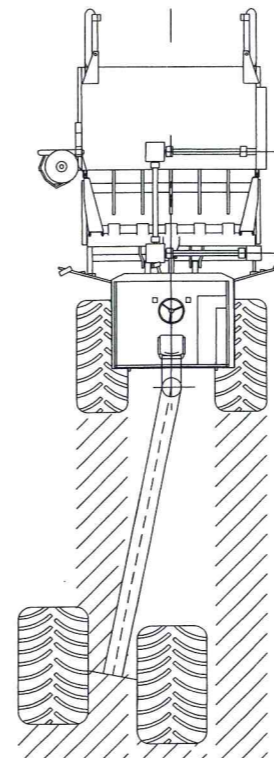

Technical Data and Description:

Motor:	MAN D 2866 LF 09	Ring elevator:	2 cam fabric belts with steel carriers
Motor rating:	308 kw (420 hp)	Distribution of beets in holding tank:	Scroll with left- and right-handed thread
Drive:	Mechanical axle at front and rear, driven by cardan shafts; between the two axles a hydrostatically operated two-speed gearbox	Holding tank base:	Consisting of transverse and longitudinal slat conveyors with 4 high duty driving chains each, hardened and tempered
Axles:	Heavy planetary steering axle in the rear, portal axle in the front, with brakes	Unloading:	Only possible in sequential switching; unloading elevator - transverse slat conveyor - longitudinal slat conveyor
Blocks:	Front and rear axles with controllable differential lock	Unloading elevator:	Width 1,85 m, hydraulically extendable; transfer to trailers for side loading possible even on the move
Speed:	1st. gear: 0 - 12.40 km/h infinitely variable 2nd. gear: 0 - 27.10 km/h infinitely variable	Cab:	Sound insulated, co-driver seat, 3 ventilator windows, heating, on-board computer and radio, with tilting roof light, on request air condition
Hydraulics:	Drive manufactured by Linde auxiliary drive manufactured by Danfoss	Lighting:	Fitted with allround light and sufficient headlights for night operation
Topper:	Flail topper	Monitoring device:	Beet flow via central computer; hydraulic oil and motor by acoustic signal
Scalpers:	With automatic cutting thickness control; topping thickness of all 6 knives centrally adjustable from the driver's seat; topper bar for all 6 scalpers adjustable in height from the driver's seat	Steer:	Preselectable steering combinations, 4 wheel steer, turning steer, crab steer, automatic steer
alternatively:	Hydraulically driven feeler wheel scalpers	Self lubricating system:	electronically controlled
Leaf spreader:	Spreading range adjustable from the driver's seat; hydraulically retractable for road transport and leaf belt operation	Fuel tank:	Approx. 1050 l
Leaf recovery:	By means of a conveyor belt; mounted with quick linking device; delivered with a leaf belt trailer for road transport	Holding tank capacity:	24 m ³
Lifter:	Driven polder shares, vibration can be turned on and off, linear sideways movement range of 7 cm to each other, maintenance-free by running in an oil bath, with automatic depth control via 7 driven feeler wheels walking shares, adjustable from the driver's seat	Transfer height:	Approx. 3.8 m
Row width:	at KPV 5 alternatively 45, 48, 50, 55, 60 and 65 cm at VPV 5 adjustable row 45 - 50 cm, 45 - 48 cm	Overall length:	12.00 m
Cleaning:	7 spiral rollers; 1 riddle belt (reversible); 3 turbines Infinitely variable speed adjustment of each cleaning unit, individual speed centrally adjustable from the driver's seat	Overall width:	3.00 m at row width of 45 cm = KPV 5 3.30 m at row width of 50 cm = KPV 5 3,30 m at row width of 45 - 50 cm = VPV 5
Gates:	Spring-loaded segments, spring tension preselectable in 3 steps; progressive height adjustment for all gates centrally from the driver's seat with digital indicator on LCD-display	Overall height:	3.98 m
		Space between axles:	5.10 m
		Tyres:	front: 800/65 R32 X M28 (width approx. 80 cm) rear: 73 x 44.00 - 32 NHS (width approx. 110 cm)
		Maximum transfer height of leaf belt:	Approx. 3.70 m
		Overall length of the cleaning way of the beet:	Approx. 11.00 m
		Capacity:	up to 1,5 ha/h

Subject to technical alterations!

HOLMER MASCHINENBAU GMBH

Regensburger Straße 20 · D-84069 Eggmühl · Telephone (0) 94 51 / 9 30 30 · Telefax (0) 94 51 / 33 70